

Safire

**The rapid-acquisition IT platform
that mitigates risk and reduces cost
and schedule overruns.**

Connecting Innovation & Automation

WHAT IS SAFIRE

Safire transforms poorly defined project requirements into a more complete understanding of objectives. Through Machine Learning (ML) and Natural Language Processing (NLP) algorithms, Safire identifies unique relationships between projects – mining massive amounts of data so you can determine project cost, schedule, and risk more accurately and efficiently.

ACCURACY & EFFICIENCY

Safire's ML and NLP creates unique relationships from your requirements. By comparing the relationships it generates from your requirements to the data and relationships generated from previous efforts, Safire can provide recommendations that fill gaps and guide users to complete project requirements with greater accuracy and speed.

REDUCING RISK

In addition to reducing the risk of cost and schedule overruns from faulty, incomplete requirements, Safire also facilitates the creation of a Minimum Viable Product (MVP) that can be tested and changed early, mitigating and managing risk early. Future risk is mitigated as well, as Safire continually updates its ML and NLP, getting smarter with every use.

PLATFORM OVERVIEW

Safire uses a Requirement Analysis Component to provide an organic interface that compliments the contractor's approach by guiding users to produce a complete and accurate work package or requirement.

To do this, users enter requirements into Safire, where they are checked against a massive database of previous requirements. Safire analyzes and translates those requirements, finds incomplete or missing information, and makes recommendations based on its ML database.

Once requirements are complete, Safire creates agile sprint packages that can be developed quickly and inexpensively. This allows users to create a minimally viable product that can be tested early and altered before moving forward, embodying the "fail fast, fail early" concept.

Upon completion and validation of the requirements, Safire learns from the whole experience and updates its correlation engine, storing all gathered and learned data in order to maintain and provide the best recommendations possible for future applications. In other words, the more you use Safire, the smarter it becomes.

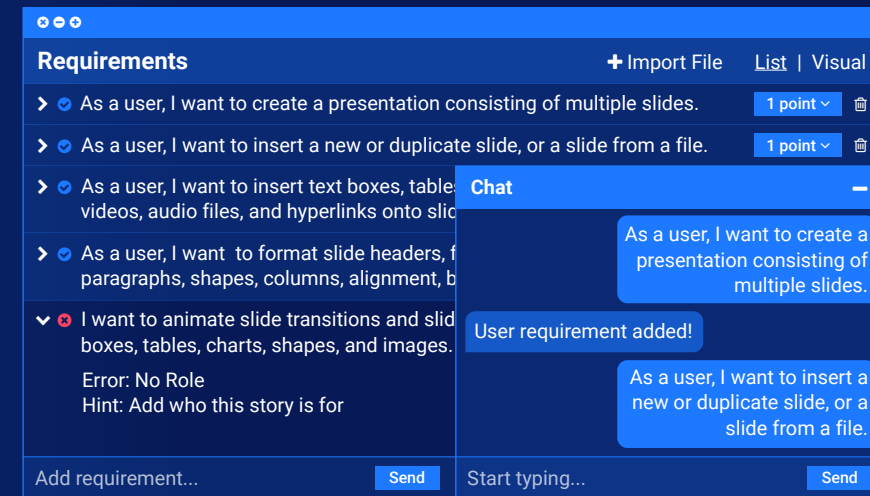

GATHERING REQUIREMENTS

Safire makes it easy to gather project requirements. Through a user-friendly interface with chat assistance, and with the guidance and information provided by Safire's NLP and ML, users can create, refine, and complete project requirements with confidence and ease.

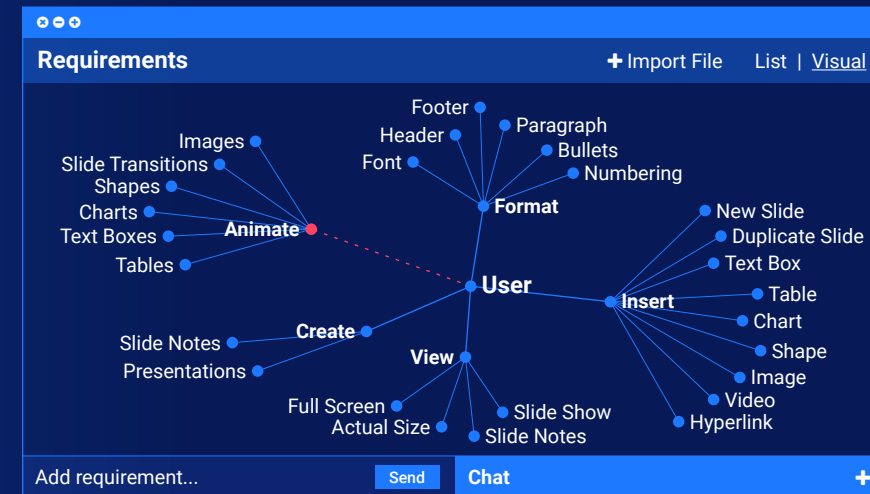

GAP ANALYSIS

When a requirement is missing, incomplete, or incorrect, Safire will alert users to errors and provide recommendations derived from NLP and ML algorithms. Safire's ability to display requirements in multiple views makes it easy for users to identify and correct errors.

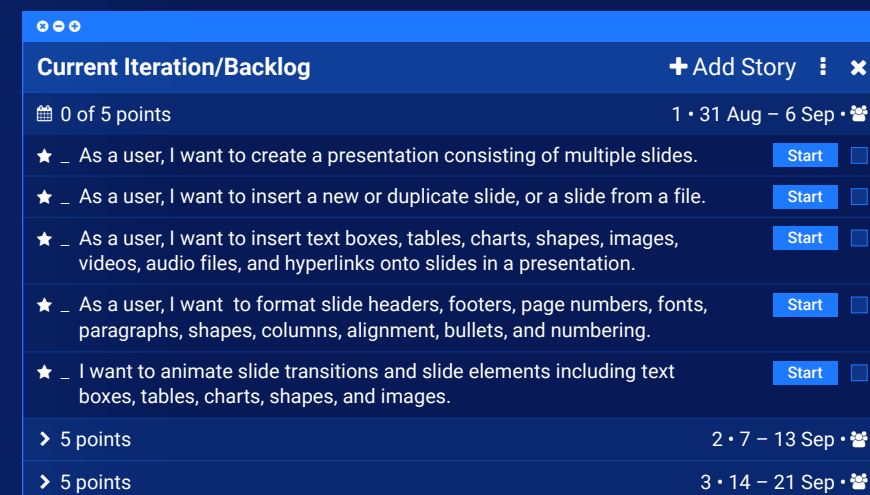

SPRINT PACKAGES

Safire translates your completed requirements and organizes them into sprint packages which can be developed, tested, and validated. Validated sprints and current project attributes become updates to Safire's correlation engine for ML to utilize in relevant future efforts.

Get In Touch

APRIL GOODWIN

Director of Marketing, SYRDEC

agoodwin@syrdec.com

770.722.2262

SYRDEC

Surany Research & Development, LLC.

info@syrdec.com

syrdec.com

